

### TECHNICAL INFORMATION

Roasting area	850 mm x 6 spit rods
Maximum capacity	24 chickens
Fire up time	30 min average
Charcoal/Wood daily consumption *	Charcoal 18 – 22 kg
Broiling temperature	200 °C a 300 °C
Maximum weight per spit rod	10 – 12 Kg
Exhaust rate	3.000 m3/h
Net weight	480 kg
Electric connection	EU: 220 V / 50 Hz USA: 120 V / 60 Hz

### DIMENSIONS & WEIGHTS

Without packaging	1200x1050x1930 mm
With packaging	1330x1210x2070 mm
Weight (NET)	380 kg
Weight (with packaging)	500 kg

### INSTALLATION

Clearance with non-flammable equipment	100 mm
Clearance with flammable equipment	300 mm

\*Depends on the charcoal/wood quality.



### INCLUDED ACCESSORIES

6 Spit Rods // 18 double spit forks for chickens // 12 single spit forks for chickens// Poker//  
Ash pan drawer // Grease tray // Grease evacuation tap //Fire bricks //Lights x2 // Packaging

### OPTIONAL ACCESSORIES

Extra spit rods// Extra spit forks// Roasting baskets



### TECHNICAL DRAWINGS

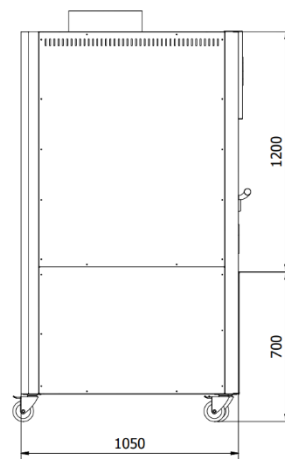
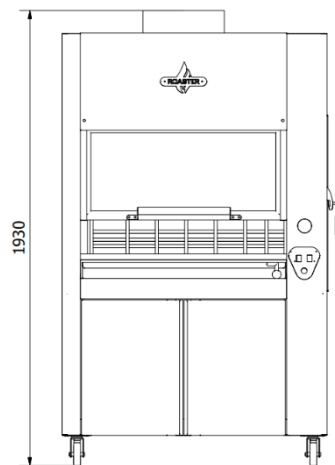
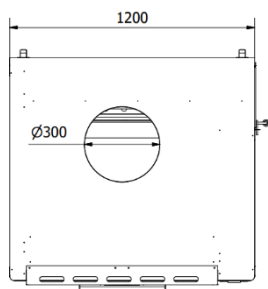

\*Dimensions in mm

\*The rotisseries are subject to technical and design changes without previous notice.

