

Drawing



Hendi B.V.
 Steenoven 21
 3911 TX Rhenen
 The Netherlands

Batch #
 401093 and up

Appliance part#
 239711

Description
 Induction cooker 3500W

Date	05-06-2014	Revision #	Revision version 1.4
Revision	New version main pcb and new version sensor with thermal fuse.		

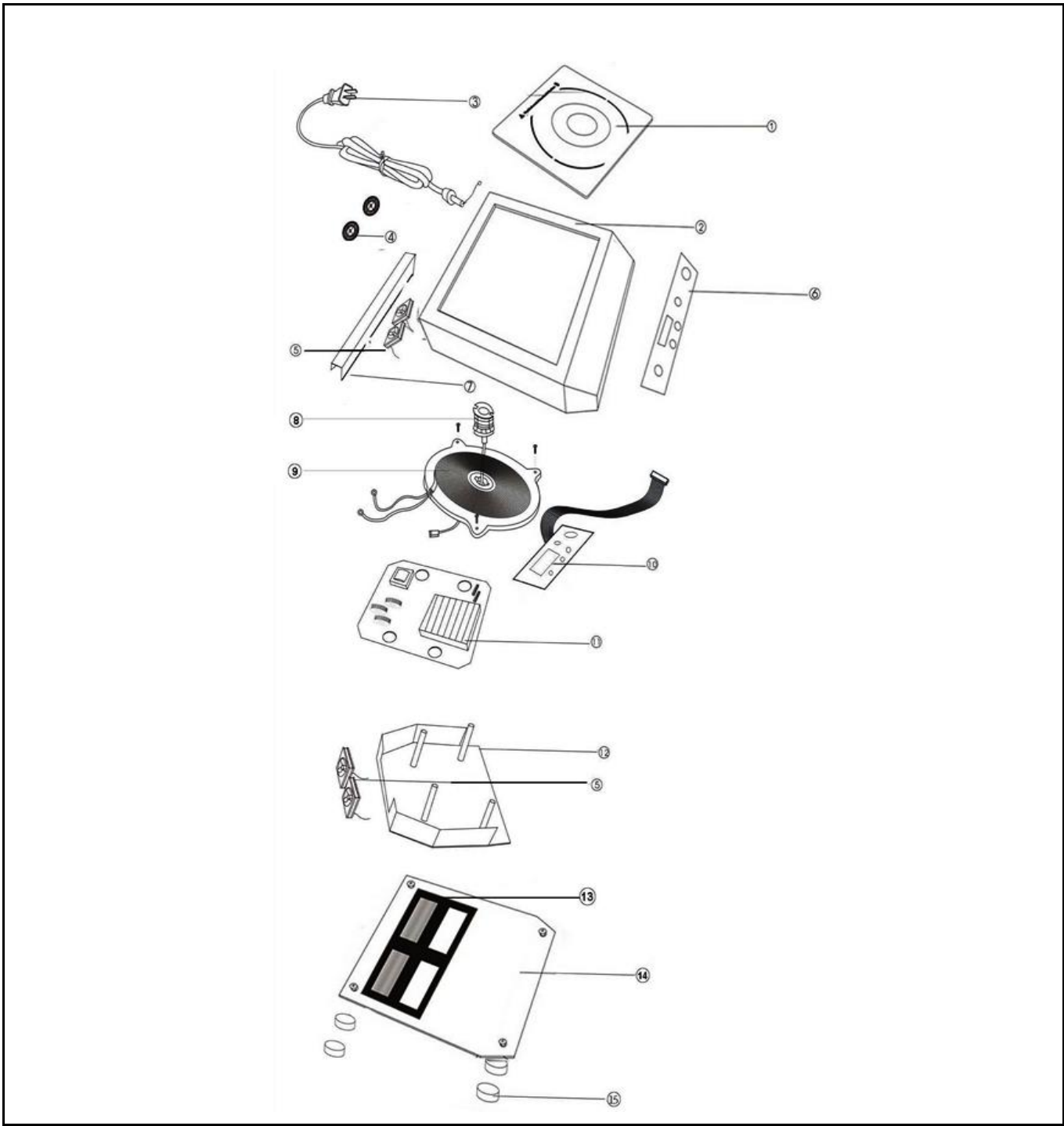

Bill of materials (BOM)

 HENDI <small>FOOD SERVICE EQUIPMENT</small> Hendi B.V. Steenoven 21 3911 TX Rhenen The Netherlands	Batch #	Appliance part#
	401093 and up	239711
	Description	
Induction cooker 3500W		

Date	05-06-2014	Revision #	Revision version 1.4
Revision	New version main pcb and new version sensor with thermal fuse.		

Item	Description	Part#	Quantity	Remark	Picture
1	Glass plate	nss	1	Available as 929964	
2	Upper housing	929964	1	Incl item 1	
3	Power cord	929353	1		
4	Cover fan	n/a	2		
5	Fan 18V	901441	4		
6	Display glass	nss	1	Available as 929964	
7	Bracket	n/a	1		
8	Sensor (with thermal fuse)	932582	1		
9	Main coil	901380	1		
10	Control pcb	929971	1		
11	Main pcb	932599	1		
12	Plastic bracket	n/a	1		
13	Filter	929759	1		
14	Bottom cover	n/a	1		
15	Feet	901373	4		

n/a -> not available

nss -> not sold separately

Wiring diagram

 <p>Hendi B.V. Steenoven 21 3911 TX Rhenen The Netherlands</p>	Batch #	Appliance part#
	401093 and up	239711
	Description	
	Induction cooker 3500W	

Date	05-06-2014	Revision #	Revision version 1.4
Revision	New version main pcb and new version sensor with thermal fuse.		

